

0646-001

Pet 94-69. Drexel PUD 2-8-95

94



SANTA CRUZ

A. P. U. D.
SITUATED IN SECTION 19, TOWNSHIP 45 SOUTH, RANGE 43 EAST
PALM BEACH COUNTY, FLORIDA
MARCH 1995 SHEET 1 OF 3

DEDICATION/RESERVATION:
KNOW ALL MEN BY THESE PRESENTS THAT SANTA CRUZ, INC., A MARYLAND CORPORATION, OWNERS OF THE LAND SHOWN HEREON, BEING IN SECTION 19, TOWNSHIP 45 SOUTH, RANGE 43 EAST, PALM BEACH COUNTY, FLORIDA, SHOWN HEREON AS "SANTA CRUZ" BEING MORE PARTICULARLY DESCRIBED AS FOLLOWS:

Commencing at the Southwest corner of said Section 19; THENCE North 87°32'45" East along the South line of the Southwest Quarter of said Section 19, a distance of 40.03 feet to a line 40.00 feet East of and parallel with the West line of the Southwest Quarter of said Section 19; THENCE North 00°15'10" West along said parallel line, a distance of 25.02 feet to a point on a line 25.00 feet North of and parallel with the South line of the Southwest Quarter of said Section 19 and the POINT OF BEGINNING; THENCE continue North 00°15'10" West, a distance of 845.74 feet; THENCE North 03°14'39" East, a distance of 180.34 feet to a line 51.00 feet East of and parallel with the West line of the Southwest Quarter of said Section 19; THENCE North 00°15'10" West along said parallel line, a distance of 300.00 feet; THENCE North 44°47'26" East, a distance of 56.61 feet to the South Right-of-Way line of Old Boynton West Road as described in that Right-of-Way Warranty Deed recorded in Official Records Book 6778, Page 1137 of the Public Records of Palm Beach County, Florida; THENCE North 89°50'01" East along said South Right-of-Way line, a distance of 564.37 feet to the West line of Oakwood Plat II, as recorded in Plat Book 48, Pages 44 and 45 of the Public Records of Palm Beach County, Florida; THENCE South 00°31'54" East along said West line, a distance of 1341.01 feet to a line 25.00 feet North of and parallel with the South line of the Southwest Quarter of said Section 19; THENCE South 87°32'45" West along said parallel line, a distance of 622.42 feet to the POINT OF BEGINNING.

LYING IN PALM BEACH COUNTY, FLORIDA, CONTAINING 19.097 ACRES, MORE OR LESS. HAVE CAUSED THE SAME TO BE SURVEYED AND PLATTED AS SHOWN HEREON AND DO HEREBY DEDICATE/RESERVE AS FOLLOWS:

- PRIVATE INGRESS/EGRESS AND DRAINAGE TRACT:
TRACT "A", AS SHOWN HEREON, IS HEREBY RESERVED FOR THE SANTA CRUZ HOMEOWNERS ASSOCIATION, INC., A FLORIDA NOT-FOR-PROFIT CORPORATION, ITS SUCCESSORS AND ASSIGNS, AS A PARKING TRACT SERVING ADJUTING LOTS FOR INGRESS, EGRESS, UTILITIES, DRAINAGE, AND OTHER PURPOSES NOT INCONSISTENT WITH THIS RESERVATION, AND IS THE PERPETUAL MAINTENANCE OBLIGATION OF SAID ASSOCIATION, ITS SUCCESSORS AND ASSIGNS, WITHOUT RECOURSE TO PALM BEACH COUNTY.
- PALM BEACH COUNTY SHALL HAVE THE RIGHT, BUT NOT THE OBLIGATION, TO MAINTAIN ANY PORTION OF THE DRAINAGE SYSTEM ENCOMPASSED BY THIS PLAT WHICH IS ASSOCIATED WITH THE DRAINAGE OF PUBLIC STREETS, INCLUDING THE RIGHT TO CONDUCT AND PERFORM ANY AND ALL DRAINAGE, LAKE MAINTENANCE, AND LAKE MAINTENANCE ACCESS EASEMENTS ASSOCIATED WITH SAID DRAINAGE SYSTEM.
- WATER MANAGEMENT TRACT:
TRACT "B", AS SHOWN HEREON, IS HEREBY RESERVED FOR THE SANTA CRUZ HOMEOWNERS ASSOCIATION, INC., A FLORIDA NOT-FOR-PROFIT CORPORATION, ITS SUCCESSORS AND ASSIGNS, FOR STORMWATER MANAGEMENT AND DRAINAGE PURPOSES AND IS THE PERPETUAL MAINTENANCE OBLIGATION OF SAID ASSOCIATION, ITS SUCCESSORS AND ASSIGNS, WITHOUT RECOURSE TO PALM BEACH COUNTY.
- DRAINAGE AND LAKE MAINTENANCE/ACCESS EASEMENTS:
THE DRAINAGE EASEMENTS AS SHOWN HEREON ARE HEREBY DEDICATED IN PERPETUITY FOR DRAINAGE PURPOSES. THE MAINTENANCE OF ALL DRAINAGE FACILITIES LOCATED THEREIN SHALL BE THE PERPETUAL MAINTENANCE OBLIGATION OF THE SANTA CRUZ HOMEOWNERS ASSOCIATION, INC., A FLORIDA NOT-FOR-PROFIT CORPORATION, ITS SUCCESSORS AND ASSIGNS, WITHOUT RECOURSE TO PALM BEACH COUNTY.
- THE LAKE MAINTENANCE EASEMENT AS SHOWN HEREON IS HEREBY RESERVED FOR THE SANTA CRUZ HOMEOWNERS ASSOCIATION, INC., A FLORIDA NOT-FOR-PROFIT CORPORATION, ITS SUCCESSORS AND ASSIGNS, FOR ACCESS TO STORMWATER MANAGEMENT AND DRAINAGE FACILITIES LOCATED WITHIN THE ASSOCIATED WATER MANAGEMENT TRACT OR PURPOSES OF PERFORMING ANY AND ALL MAINTENANCE ACTIVITIES PURSUANT TO THE MAINTENANCE OBLIGATION OF SAID ASSOCIATION, ITS SUCCESSORS AND ASSIGNS, WITHOUT RECOURSE TO PALM BEACH COUNTY.
- THE LAKE MAINTENANCE ACCESS EASEMENT AS SHOWN HEREON IS HEREBY RESERVED FOR THE SANTA CRUZ HOMEOWNERS ASSOCIATION, INC., A FLORIDA NOT-FOR-PROFIT CORPORATION, ITS SUCCESSORS AND ASSIGNS, FOR ACCESS TO STORMWATER MANAGEMENT AND DRAINAGE FACILITIES LOCATED WITHIN THE ASSOCIATED WATER MANAGEMENT TRACT FOR PURPOSES OF PERFORMING ANY AND ALL MAINTENANCE ACTIVITIES PURSUANT TO THE MAINTENANCE OBLIGATION OF SAID ASSOCIATION, ITS SUCCESSORS AND ASSIGNS, WITHOUT RECOURSE TO PALM BEACH COUNTY.
- PALM BEACH COUNTY SHALL HAVE THE RIGHT, BUT NOT THE OBLIGATION, TO MAINTAIN ANY PORTION OF THE DRAINAGE SYSTEM ENCOMPASSED BY THIS PLAT WHICH IS ASSOCIATED WITH THE DRAINAGE OF PUBLIC STREETS, INCLUDING THE RIGHT TO UTILIZE FOR PROPER PURPOSES ANY AND ALL DRAINAGE, LAKE MAINTENANCE, AND LAKE MAINTENANCE ACCESS EASEMENTS ASSOCIATED WITH SAID DRAINAGE SYSTEM.
- UTILITY EASEMENTS:
THE UTILITY EASEMENTS AS SHOWN HEREON ARE HEREBY DEDICATED IN PERPETUITY FOR THE CONSTRUCTION AND MAINTENANCE OF UTILITY FACILITIES, INCLUDING CABLE TELEVISION SYSTEMS. THE INSTALLATION OF CABLE TELEVISION SYSTEMS SHALL NOT INTERFERE WITH THE CONSTRUCTION AND MAINTENANCE OF OTHER UTILITIES.
- LIMITED ACCESS EASEMENTS:
THE LIMITED ACCESS EASEMENT AS SHOWN HEREON ARE HEREBY DEDICATED TO THE BOARD OF COUNTY COMMISSIONERS OF PALM BEACH COUNTY, FLORIDA, FOR THE PURPOSE OF CONTROL AND JURISDICTION OVER ACCESS RIGHTS.
- LITTORAL ZONE/PRESERVATION/CONSERVATION AREAS:
TRACT "D", AS SHOWN HEREON, IS HEREBY RESERVED FOR LITTORAL ZONE AND WATER MANAGEMENT PURPOSES FOR THE SANTA CRUZ HOMEOWNERS ASSOCIATION, INC., A FLORIDA NOT-FOR-PROFIT CORPORATION, ITS SUCCESSORS AND ASSIGNS, AND IS THE PERPETUAL MAINTENANCE OBLIGATION OF SAID ASSOCIATION, ITS SUCCESSORS AND ASSIGNS, WITHOUT RECOURSE TO PALM BEACH COUNTY. IT IS A PUNISHABLE VIOLATION OF PALM BEACH COUNTY LAWS, ORDINANCES, CODES, REGULATIONS AND APPROVALS TO ALTER THE APPROVED SLOPES, CONTOURS OR CROSS-SECTIONS, OR TO CHEMICALLY OR PHYSICALLY REMOVE, DAMAGE, DESTROY OR TRIM ANY PLANTS WITHIN SAID TRACT WITHOUT THE PRIOR WRITTEN CONSENT OF THE PALM BEACH COUNTY DEPARTMENT OF ENVIRONMENTAL RESOURCES MANAGEMENT.
- RECREATION/PRIVATE CIVIC AREAS:
TRACTS "B" & "C", RECREATION/PRIVATE CIVIC AREAS, AS SHOWN HEREON, ARE HEREBY RESERVED FOR THE SANTA CRUZ HOMEOWNERS ASSOCIATION, INC., A FLORIDA NOT-FOR-PROFIT CORPORATION, ITS SUCCESSORS AND ASSIGNS, FOR RECREATIONAL PURPOSES AND ARE THE PERPETUAL MAINTENANCE OBLIGATION OF SAID ASSOCIATION, ITS SUCCESSORS AND ASSIGNS, WITHOUT RECOURSE TO PALM BEACH COUNTY.
- OPEN SPACE:
TRACTS "C, D, E, F, G, H, I, J, K, M, & N", AS SHOWN HEREON, ARE HEREBY RESERVED FOR THE SANTA CRUZ HOMEOWNERS ASSOCIATION, INC., A FLORIDA NOT-FOR-PROFIT CORPORATION, ITS SUCCESSORS AND ASSIGNS, FOR OPEN SPACE PURPOSES AND ARE THE PERPETUAL MAINTENANCE OBLIGATION OF SAID ASSOCIATION, ITS SUCCESSORS AND ASSIGNS, WITHOUT RECOURSE TO PALM BEACH COUNTY.
- LANDSCAPE BUFFER EASEMENTS:
THE LANDSCAPE BUFFER EASEMENTS, AS SHOWN HEREON, ARE HEREBY RESERVED FOR THE SANTA CRUZ HOMEOWNERS ASSOCIATION, INC., A FLORIDA NOT-FOR-PROFIT CORPORATION, ITS SUCCESSORS AND ASSIGNS, FOR BUFFER PURPOSES AND IS THE PERPETUAL MAINTENANCE OBLIGATION OF SAID ASSOCIATION, ITS SUCCESSORS AND ASSIGNS, WITHOUT RECOURSE TO PALM BEACH COUNTY.

IN WITNESS WHEREOF, THE ABOVE-NAMED CORPORATION, HAS CAUSED THESE PRESENTS TO BE SIGNED BY ITS PRESIDENT AND ITS CORPORATE SEAL TO BE AFFIXED HERETO BY AND WITH THE AUTHORITY OF ITS BOARD OF DIRECTORS, THIS 17th DAY OF AUGUST, 1995.

ATTEST: *Judith Fitzwater*
JUDITH FITZWATER, SECRETARY
SANTA CRUZ, INC., A MARYLAND CORPORATION
BY: *Scott Porten*
SCOTT PORTEN, PRESIDENT

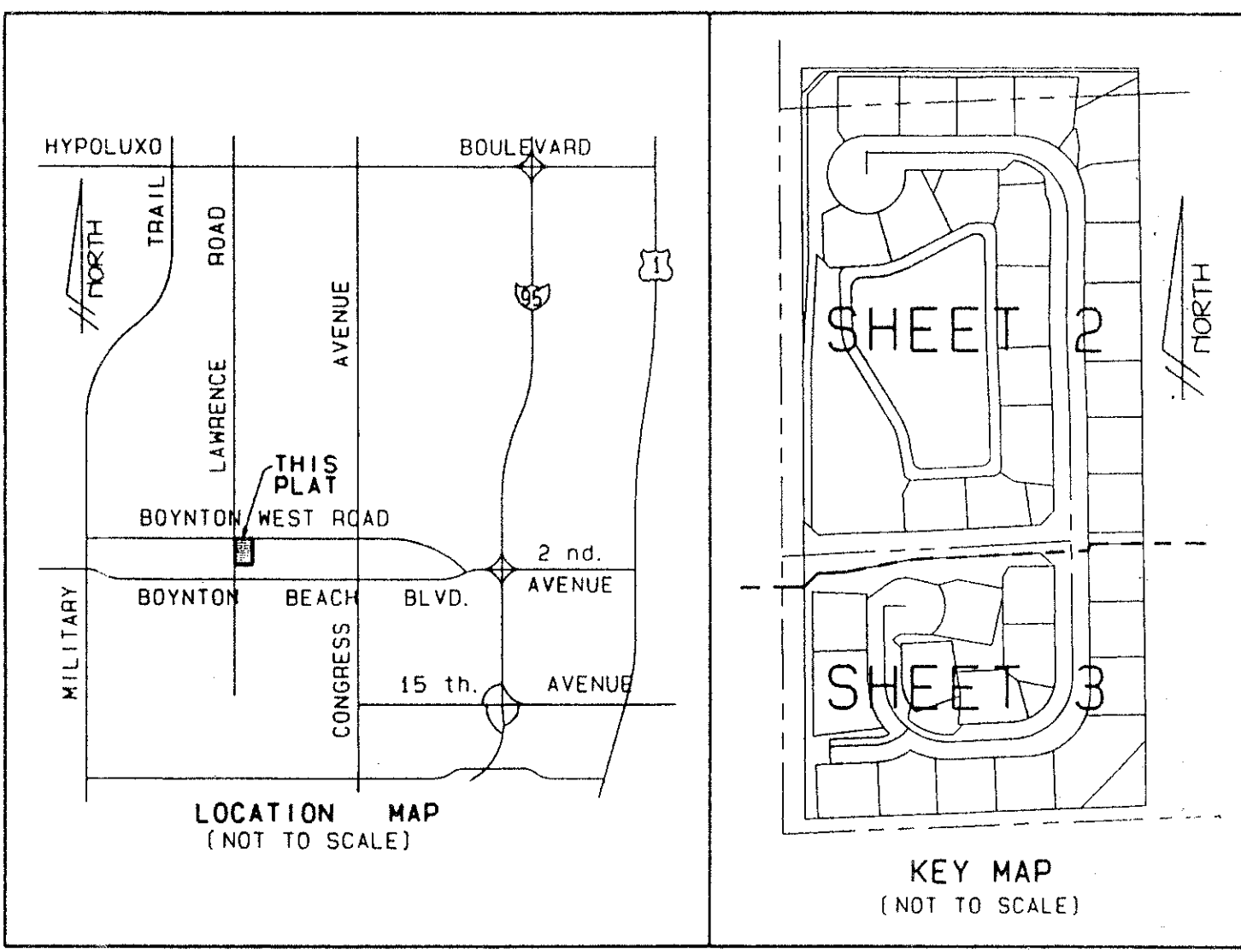

TOTAL AREA OF THIS PLAT	19.097 AC
TOTAL NUMBER OF UNITS	152 DU
DESITY	7.9 DU/AC
TRACT A (PRIVATE INGRESS/EGRESS AND DRAINAGE TRACT)	3.983 AC - 20.9%
TRACT B (RECREATION TRACT)	1.259 AC - 6.6%
TRACT C (RECREATION TRACT)	0.370 AC - 1.9%
TRACT D (WATER MANAGEMENT)	2.177 AC - 11.4%
TRACT E (LITTORAL ZONE)	0.190 AC - 1.0%
TRACTS C, D, E, F, G, H, I, J, K, M, & N (OPEN SPACE)	1.654 AC - 8.7%
BLOCKS 1 THRU 35	9.464 AC - 49.5%
TOTAL	19.097 AC - 100.0%

MORTGAGEE'S CONSENT
STATE OF FLORIDA } SS
COUNTY OF BROWARD }
THE UNDERSIGNED HEREBY CERTIFIES THAT IT IS THE HOLDER OF A MORTGAGE UPON THE PROPERTY DESCRIBED HEREON AND DOES HEREBY JOIN IN AND CONSENT TO THE DEDICATION OF THE LAND DESCRIBED IN SAID DEDICATION BY THE OWNER THEREOF AND AGREES THAT ITS MORTGAGE WHICH IS RECORDED IN OFFICIAL RECORD BOOK 8660, AT PAGE 1931 OF THE PUBLIC RECORDS OF PALM BEACH COUNTY, FLORIDA, SHALL BE SUBORDINATED TO THE DEDICATION SHOWN HEREON.

IN WITNESS WHEREOF, THE SAID CORPORATION HAS CAUSED THESE PRESENTS TO BE SIGNED BY ITS VICE PRESIDENT AND ITS CORPORATE SEAL TO BE AFFIXED HERETO BY AND WITH THE AUTHORITY OF ITS BOARD OF DIRECTORS THIS 17th DAY OF AUGUST, 1995.

BARNETT BANK OF BROWARD COUNTY, N.A.
A NATIONAL BANKING ASSOCIATION
BY: *Jeffrey H. Cannon*
JEFFREY H. CANNON, VICE PRESIDENT

WITNESS: *Richard H. Smith*
RICHARD H. SMITH

ACKNOWLEDGEMENT:
STATE OF FLORIDA } SS
COUNTY OF PALM BEACH }
BEFORE ME PERSONALLY APPEARED SCOTT PORTEN AND JUDITH FITZWATER WHO ARE PERSONALLY KNOWN TO ME OR HAVE PRODUCED AS IDENTIFICATION, AND WHO EXECUTED THE FOREGOING INSTRUMENT AS PRESIDENT AND SECRETARY, RESPECTIVELY, OF SANTA CRUZ, INC., A MARYLAND CORPORATION, AND SEVERALLY ACKNOWLEDGED TO AND BEFORE ME THAT THEY EXECUTED SUCH INSTRUMENT AS SUCH OFFICERS OF SAID CORPORATION, AND THAT THE SEAL AFFIXED TO THE FOREGOING INSTRUMENT IS THE CORPORATE SEAL OF SAID CORPORATION AND THAT IT WAS AFFIXED TO SAID INSTRUMENT BY DUE AND REGULAR CORPORATE AUTHORITY, AND THAT SAID INSTRUMENT IS THE FREE ACT AND DEED OF SAID CORPORATION.

WITNESS MY HAND AND OFFICIAL SEAL THIS 17th DAY OF AUGUST, 1995.

MY COMMISSION EXPIRES: *August 28, 1998*

Judith Fitzwater
JUDITH FITZWATER, SECRETARY

ACCEPTANCE OF RESERVATIONS
SANTA CRUZ HOMEOWNERS ASSOCIATION
STATE OF FLORIDA } SS
COUNTY OF PALM BEACH }
THE SANTA CRUZ HOMEOWNERS ASSOCIATION, INC., A FLORIDA NOT-FOR-PROFIT CORPORATION, HEREBY ACCEPTS THE RESERVATIONS TO SAID ASSOCIATION AS STATED AND SHOWN HEREON, AND HEREBY ACCEPTS ITS MAINTENANCE OBLIGATION FOR SAME AS STATED HEREON, THIS 17th DAY OF AUGUST, 1995.

SANTA CRUZ HOMEOWNERS ASSOCIATION, INC.
A FLORIDA NOT-FOR-PROFIT CORPORATION
BY: *Judith Fitzwater*
JUDITH FITZWATER, PRESIDENT

WITNESS: *Tracy Novack*
TRACY NOVACK
Michael S. Goldberg
MICHAEL S. GOLDBERG

ACKNOWLEDGEMENT:
STATE OF FLORIDA } SS
COUNTY OF PALM BEACH }
BEFORE ME PERSONALLY APPEARED JUDITH FITZWATER WHO IS PERSONALLY KNOWN TO ME, OR HAS PRODUCED AS IDENTIFICATION AND DID/DID NOT TAKE AN OATH, AND WHO EXECUTED THE FOREGOING INSTRUMENT AS PRESIDENT OF SANTA CRUZ HOMEOWNERS ASSOCIATION, INC., A FLORIDA NOT-FOR-PROFIT CORPORATION, AND SEVERALLY ACKNOWLEDGED TO AND BEFORE ME THAT HE EXECUTED SUCH INSTRUMENT AS SUCH OFFICER OF SAID CORPORATION, AND THAT THE SEAL AFFIXED TO THE FOREGOING INSTRUMENT IS THE CORPORATE SEAL OF SAID CORPORATION AND THAT IT WAS AFFIXED TO SAID INSTRUMENT BY DUE AND REGULAR CORPORATE AUTHORITY, AND THAT SAID INSTRUMENT IS THE FREE ACT AND DEED OF SAID CORPORATION.

WITNESS MY HAND AND OFFICIAL SEAL THIS 17th DAY OF AUGUST, 1995.

MY COMMISSION EXPIRES: *August 28, 1998*

Karen J. McKinney
KAREN J. MCKINNEY, NOTARY PUBLIC

ACKNOWLEDGEMENT:
STATE OF FLORIDA } SS
COUNTY OF BROWARD }
BEFORE ME PERSONALLY APPEARED JEFFREY H. CANNON AND BERNADETTE MAZZA WHO ARE PERSONALLY KNOWN TO ME OR HAVE PRODUCED AS IDENTIFICATION AND WHO EXECUTED THE FOREGOING INSTRUMENT AS VICE PRESIDENTS OF BARNETT BANK OF BROWARD COUNTY NATIONAL BANKING ASSOCIATION, AND SEVERALLY ACKNOWLEDGED TO AND BEFORE ME THAT THEY EXECUTED SUCH INSTRUMENT AS SUCH OFFICERS OF SAID CORPORATION, AND THAT THE SEAL AFFIXED TO THE FOREGOING INSTRUMENT IS THE CORPORATE SEAL OF SAID CORPORATION AND THAT IT WAS AFFIXED TO SAID INSTRUMENT BY DUE AND REGULAR CORPORATE AUTHORITY, AND THAT SAID INSTRUMENT IS THE FREE ACT AND DEED OF SAID CORPORATION.

WITNESS MY HAND AND OFFICIAL SEAL THIS 14th DAY OF AUGUST, 1995.

MY COMMISSION EXPIRES: *August 28, 1998*

Jeffrey H. Cannon
JEFFREY H. CANNON, VICE PRESIDENT

Bernadette Mazza
BERNADETTE MAZZA, VICE PRESIDENT

MORTGAGEE'S CONSENT
STATE OF FLORIDA } SS
COUNTY OF BROWARD }
THE UNDERSIGNED HEREBY CERTIFIES THAT IT IS THE HOLDER OF A MORTGAGE UPON THE PROPERTY DESCRIBED HEREON AND DOES HEREBY JOIN IN AND CONSENT TO THE DEDICATION OF THE LAND DESCRIBED IN SAID DEDICATION BY THE OWNER THEREOF AND AGREES THAT ITS MORTGAGE WHICH IS RECORDED IN OFFICIAL RECORD BOOK 8860 AT PAGE 1979 OF THE PUBLIC RECORDS OF PALM BEACH COUNTY, FLORIDA, SHALL BE SUBORDINATED TO THE DEDICATION SHOWN HEREON.

IN WITNESS WHEREOF, THE SAID CORPORATION HAS CAUSED THESE PRESENTS TO BE SIGNED BY ITS VICE PRESIDENT AND ITS CORPORATE SEAL TO BE AFFIXED HERETO BY AND WITH THE AUTHORITY OF ITS BOARD OF DIRECTORS THIS 17th DAY OF AUGUST, 1995.

HAMMER FINANCIAL CORPORATION,
A MARYLAND CORPORATION
BY: *Howard Michnick*
HOWARD MICHNICK, VICE PRESIDENT

WITNESS: *Michael S. Goldberg*
MICHAEL S. GOLDBERG
Scott Porten
SCOTT PORTEN

ACKNOWLEDGEMENT
STATE OF FLORIDA } SS
COUNTY OF BROWARD }
BEFORE ME PERSONALLY APPEARED HOWARD MICHNICK WHO IS PERSONALLY KNOWN TO ME, OR HAS PRODUCED AS IDENTIFICATION AND WHO EXECUTED THE FOREGOING INSTRUMENT AS VICE PRESIDENT OF HAMMER FINANCIAL CORPORATION, A MARYLAND CORPORATION, AND SEVERALLY ACKNOWLEDGED TO AND BEFORE ME THAT HE EXECUTED SUCH INSTRUMENT AS SUCH OFFICER OF SAID CORPORATION, AND THAT THE SEAL AFFIXED TO THE FOREGOING INSTRUMENT IS THE CORPORATE SEAL OF SAID CORPORATION AND THAT IT WAS AFFIXED TO SAID INSTRUMENT BY DUE AND REGULAR CORPORATE AUTHORITY, AND THAT SAID INSTRUMENT IS THE FREE ACT AND DEED OF SAID CORPORATION.

WITNESS MY HAND AND OFFICIAL SEAL THIS 15th DAY OF AUGUST, 1995.

MY COMMISSION EXPIRES: *August 28, 1998*

Judith Fitzwater
JUDITH FITZWATER, SECRETARY

TITLE CERTIFICATE:
STATE OF FLORIDA } SS
COUNTY OF BROWARD }
WE, GOLDBERG & YOUNG, P.A., A PROFESSIONAL ASSOCIATION, DULY LICENSED IN THE STATE OF FLORIDA DO HEREBY CERTIFY THAT WE HAVE EXAMINED THE TITLE TO THE HEREON DESCRIBED PROPERTY; THAT WE FIND THE TITLE TO THE PROPERTY IS VESTED IN SANTA CRUZ, INC., A MARYLAND CORPORATION; THAT THE CURRENT TAXES HAVE BEEN PAID; THAT ALL MORTGAGES NOT SATISFIED OR RELEASED OR RECORDED NOR OTHERWISE TERMINATED BY LAW ARE SHOWN HEREON.

GOLDBERG & YOUNG, P.A.
A PROFESSIONAL ASSOCIATION

DATED THIS 6th DAY OF AUGUST 1995 BY *Lawrence H. Goldberg*
LAWRENCE H. GOLDBERG, VICE PRESIDENT.

PALM BEACH COUNTY APPROVAL:
COUNTY ENGINEER:
THIS PLAT IS HEREBY APPROVED FOR RECORD PURSUANT TO PALM BEACH COUNTY ORDINANCE 95-33, AND IN ACCORDANCE WITH SEC. 177.07(2), F.S., THIS 14th DAY OF AUGUST, 1995.

BY: *George T. Webb*
GEORGE T. WEBB, P.E., COUNTY ENGINEER

SURVEYOR'S CERTIFICATE:
THIS IS TO CERTIFY THAT THE PLAT SHOWN HEREON IS A TRUE AND CORRECT REPRESENTATION OF A SURVEY MADE UNDER MY RESPONSIBLE DIRECTION AND SUPERVISION; THAT SAID SURVEY IS ACCURATE TO THE BEST OF MY KNOWLEDGE AND BELIEF; THAT PERMANENT REFERENCE MONUMENTS ("P.R.M.S.") HAVE BEEN PLACED AS REQUIRED BY LAW AND THAT PERMANENT CONTROL POINTS ("P.C.P.S.") WILL BE SET UNDER THE GUARANTEES POSTED WITH THE PALM BEACH COUNTY BOARD OF COUNTY COMMISSIONERS FOR THE REQUIRED IMPROVEMENTS; AND, FURTHER, THAT THE SURVEY DATA COMPLIES WITH ALL THE REQUIREMENTS OF CHAPTER 177, FLORIDA STATUTES, AS AMENDED, AND THE ORDINANCES OF THE PALM BEACH COUNTY, FLORIDA.

DATE: *08/14/95*

Judith Fitzwater
JUDITH FITZWATER, III
PROFESSIONAL LAND SURVEYOR
FLORIDA REGISTRATION NO. 2816

NOTE:
THERE MAY BE ADDITIONAL RESTRICTIONS THAT ARE NOT RECORDED ON THIS PLAT THAT MAY BE FOUND IN THE PUBLIC RECORDS OF PALM BEACH COUNTY, FLORIDA.

PALM BEACH COUNTY ENGINEER
SURVEYOR

TAZ-487
SUBDIVISION: SANTA CRUZ
BOOK 76 PAGE 94
FLOOD ZONE C
QUAD # 20
ZONING CS PUD
SE 94-69
PUD NAME SANTA CRUZ
ZIP CODE 33436

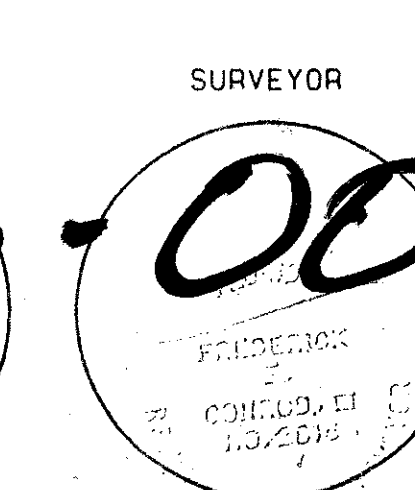
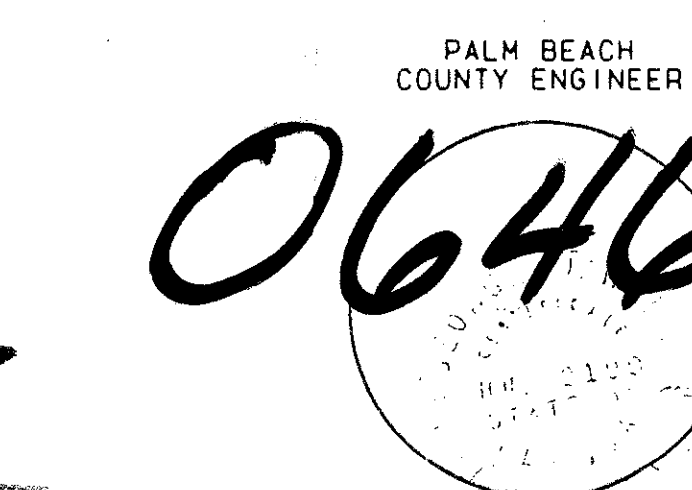
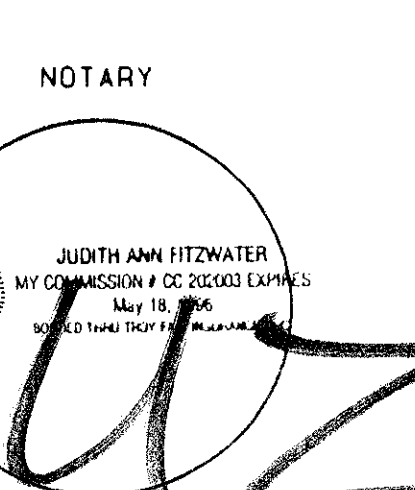
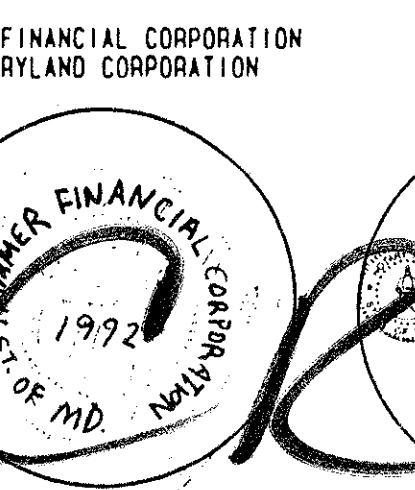
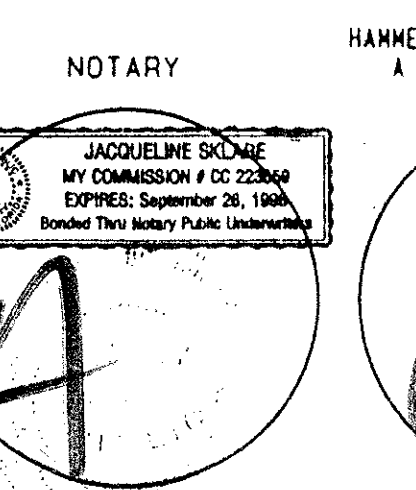
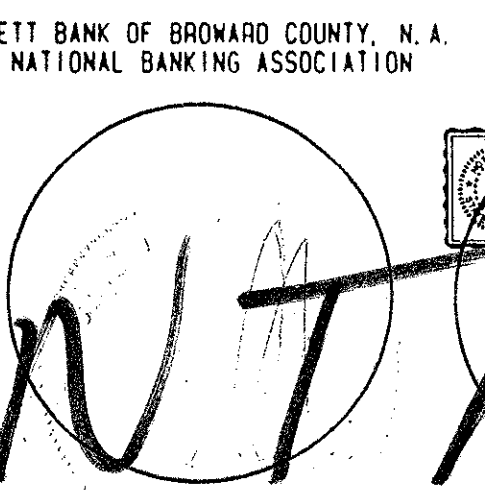
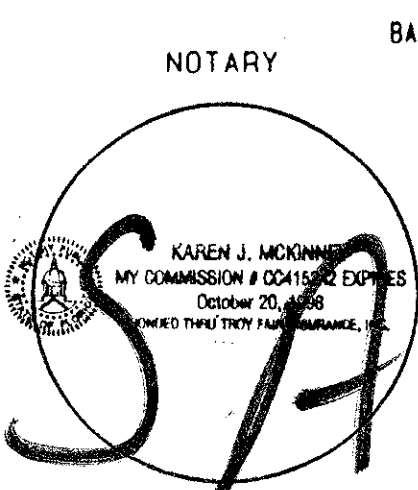
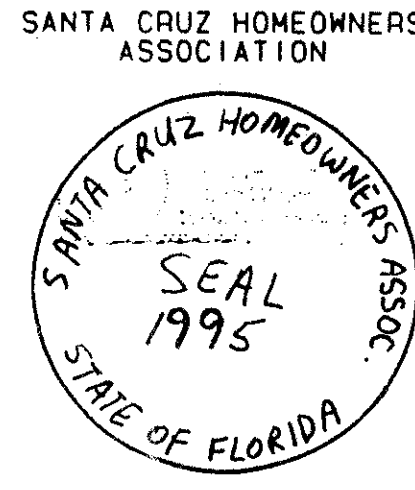
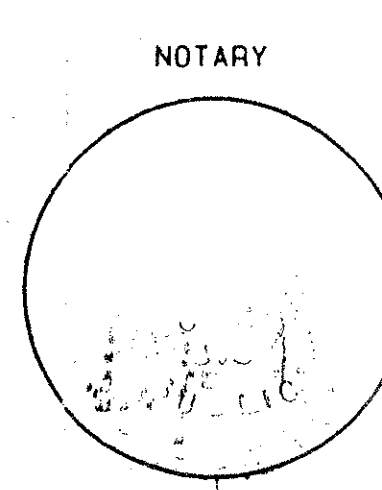

0646-001

76/94

CRAIG A. SMITH & ASSOCIATES
CONSULTING ENGINEERS-PLANNERS-SURVEYORS
1000 WEST MC NAB ROAD
POMPANO BEACH, FLORIDA, 33069
(305) 782-8222
CERT. NO. LB0003110

94-1649 RECORD PLAT
1649P1 SANTA CRUZ